



**MOVE INN ESTATES**  
MAKING THE RIGHT MOVE



**Park Avenue**

, Southall, UB1 3AP

Offers In Excess Of £525,000



## Floor Plan

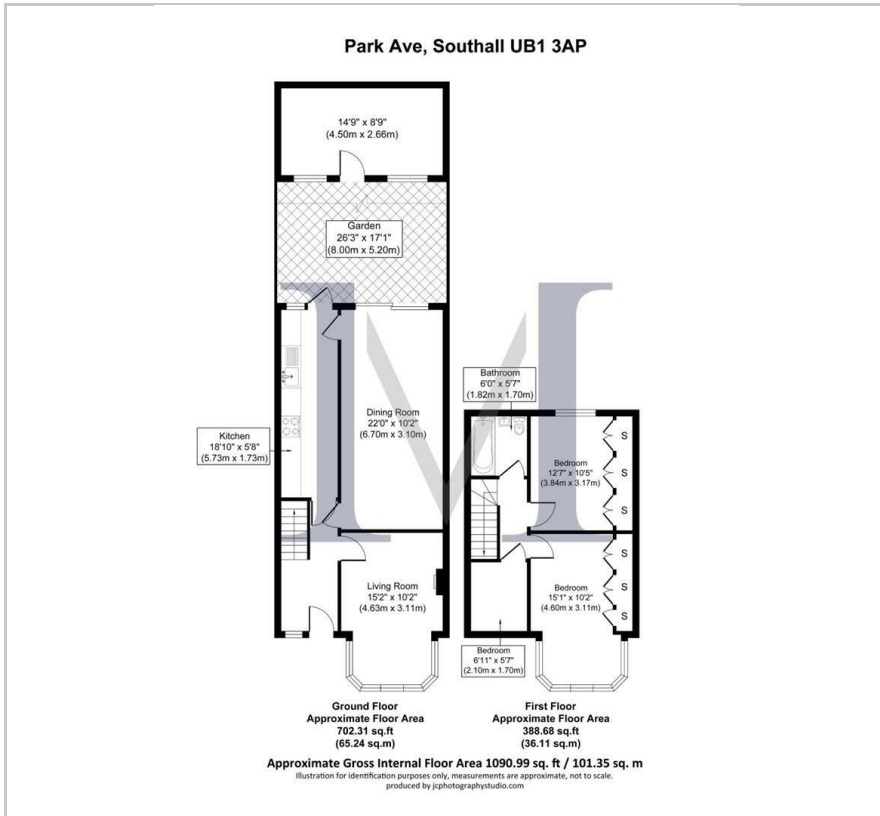

## Area Map



## Energy Efficiency Graph

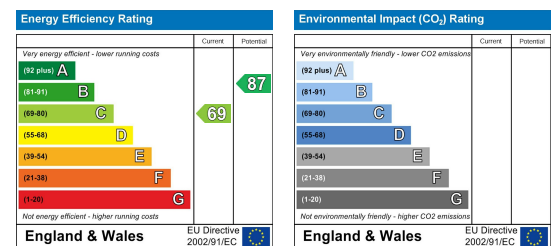

## Viewing

Please contact our Move Inn Estates - Sales Office on 0208 574 4966 if you wish to arrange a viewing appointment for this property or require further information.

- Chain free
- Three bedrooms
- Outbuilding
- Mid-terrace
- Extended
- Potential to extend (STPP)



Move Inn Estates bring to the market, this extended three bedroom terraced family situated in a highly desirable part of Southall and in walking distance to Southall Park.

The property comprises of a lounge and diner with a fully fitted kitchen and with the first floor housing three sizeable bedrooms and the main family bathroom. Externally there is off street parking to the front aspect and a private enclosed garden to the rear and an outbuilding. The property offers further scope for development (STPP).

Moments away from neighbouring towns such as Greenford and Ealing. Walking distance to local bus stops, close to schools and nearby shopping parades.

Viewings advised.



These particulars, whilst believed to be accurate are set out as a general outline only for guidance and do not constitute any part of an offer or contract. Intending purchasers should not rely on them as statements of representation of fact, but must satisfy themselves by inspection or otherwise as to their accuracy. No person in this firm's employment has the authority to make or give any representation or warranty in respect of the property.